

# 120/120 Plus

# Digital Weight Indicator



## STANDARD FEATURES

### 120

- Large .8in (20.3mm) Light Emitting Diode (LED) Display
- Configurable analog to digital measurement rate
- Power for four 350Ω load cells
- Primary/secondary units configuration: lb, kg, ounces, grams
- Five-button operation
- Two independent communication ports: (1) full duplex, (1) unidirectional or active 20mA current loop
- Standardized EDP command sets
- Programmable ticket format up to two 180-character printout
- Full front-panel digital calibration and configuration
- Tilt stand
- Three-stage digital filtering
- Consecutive transaction numbering
- Time and date (volatile)

### 120 Plus

- Large .8in backlit LCD display
- Rechargeable battery or wall adapter
- Power save feature for 700 hours of battery life
- Ten stored tare values
- Display hold (based on 3 second average)
- Time and date

## APPROVALS



120 Plus - Approvals Pending for Measurement Canada

## SPECIFICATIONS

### POWER:

#### 120/120 Plus:

Line voltages: 115 or 230VAC  
Frequency: 50 or 60Hz

#### 120 Plus:

(estimated battery life)  
60 hours with 1 x 350Ω  
40 hours with 4 x 350Ω  
Charge time 8 hours

### EXCITATION VOLTAGE:

5VDC, 4 x 350Ω or 8 x 700Ω load cells

### ANALOG SIGNAL INPUT RANGE:

-0.6mV/V - 3.0mV/V

### ANALOG SIGNAL SENSITIVITY:

0.3μV/graduation minimum,  
1.5μV/grad recommended

### RESOLUTION:

Internal resolution:  
1 million internal graduations  
Display resolution:  
10,000 displayed graduations

### MEASUREMENT RATE:

120: 30, 15, 7, 3 per second  
120 Plus: 30 per second

### SYSTEM LINEARITY:

Within 0.01% of full scale

### CIRCUIT PROTECTION:

RFI, EMI, ESD protected

### LOAD CELL CONNECTION:

Cord grip entry  
Detachable plug (optional)

### SERIAL OUTPUT:

EDP port: Full duplex RS-232  
Printer port: Output-only RS-232 or active 20mA current loop  
Both ports: 9600, 4800, 2400, 1200, 600, 300 bps; 7 or 8 data bits; even, odd or no parity

### DISPLAY:

**120:**  
0.8in (20mm), 6-digit Red Light Emitting Diode (LED) display, 7-segment digits

**120 Plus:**  
0.8in (20mm) 6-digit LCD with backlight  
7-segment digits

### STATUS ANNUNCIATORS:

Designators for: center of zero, stand still, gross, net center of zero, standstill, lb, kg, oz, g  
\*Battery, setpoint 1 & 2, HI-OK-LO, Hold

### KEYBOARD:

**120:**  
5-key flat membrane panel, tactile feel

**120 Plus:**  
zero, tare, present tare, hold, gross/net, units, numeric 0-9, clear, enter/print

### DIGITAL I/O:

120 Plus: Requires option card  
24 volt source  
3 digital inputs  
2 digital outputs

### OPERATING TEMPERATURE:

-10°C to 40°C/14°F to 104°F (legal)  
-10°C to 50°C/14°F to 122°F (industrial)

### WEIGHT:

2.6lb (1.2kg)

### RATING/MATERIAL:

Enclosure: heavy gauge ABS

### 120 APPROVALS:

NTEP -6,000 Divisions, Class III/III, CC# 03-059A1, Measurement Canada AM-5517, Class III/IIIHD at 6,000 Divisions; OIML approved, TC 7072; T 5692 at 5,000 Divisions  
CE marked

### 120 PLUS APPROVALS:

NTEP -6,000 Divisions, Class III/III, CC# 03-059A1; Measurement Canada Pending OIML approved, TC 7335; T 7334 at 10,000 Divisions

### WARRANTY:

One-year limited warranty

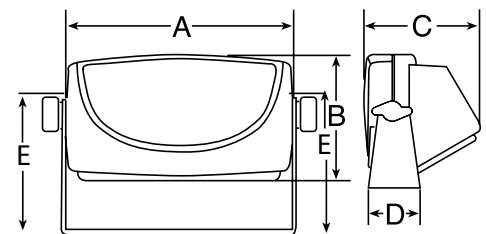

DIMENSIONS			
<b>A</b>	7.32in (1863mm)	<b>D</b>	1.65in (42mm)
<b>B</b>	6.06in (154mm)	<b>E</b>	4.76in (121mm)
<b>C</b>	3.74in (95mm)		

<b>PART #</b>	<b>DESCRIPTION</b>	<b>EST. SHIP WEIGHT</b>
<b>120</b>		
92769.....	120, Desktop 115VAC <sup>†</sup> .....	3 lb .....
92772.....	120, Desktop 230VAC, OIML/CE <sup>††</sup> .....	3 lb .....
<b>120 Plus</b>		
103632.....	120 Plus, Desktop 115/230VAC <sup>†</sup> .....	3 lb .....
107619.....	120 Plus, Desktop 115/230VAC <sup>†</sup> with digital I/O option .....	3 lb .....

**OPTIONS/ACCESSORIES**

83835.....	Load cell connector with 2-meter length pigtail (requires 103507) .....	
93205.....	Load cell connector with 6 meter length pigtail (requires 103507).....	
82505.....	6-pin socket external load cell connector (requires 103507) .....	
77925.....	Revolution <sup>®</sup> III Scale Software* .....	
103507.....	External load cell plug replaces cord grip (requires 82505 or cable 83835, 93205).....	
107620.....	Digital I/O cord for 120 Plus .....	
76699.....	Additional operating manual for 120.....	
105914.....	Additional operating manual for 120 Plus .....	

**Primary Component Parts for 120**

78609.....	Board assembly for use with external LC connector.....	
96293.....	Board assembly for use with internal LC connector.....	
78610.....	Overlay membrane switch.....	
78611.....	Power supply, 115 VAC.....	
78612.....	Power supply, 230 VAC (2-pin Europe) .....	

**Primary Component Parts for 120 Plus**

103634.....	CPU/Display board assembly.....	
103635.....	Overlay membrane switch.....	
103636.....	Power supply, 115 VAC/230 VAC.....	
103637.....	Rechargeable Battery .....	

\* Revolution III can be downloaded for FREE at [www.ricelake.com](http://www.ricelake.com)

External load cell plug replaces cord grip

